

1667/128

1654/25

1667/133

1667/136

1667/129

1310/4

1667/85

II
1924

1667/106

1667/123

1667/75

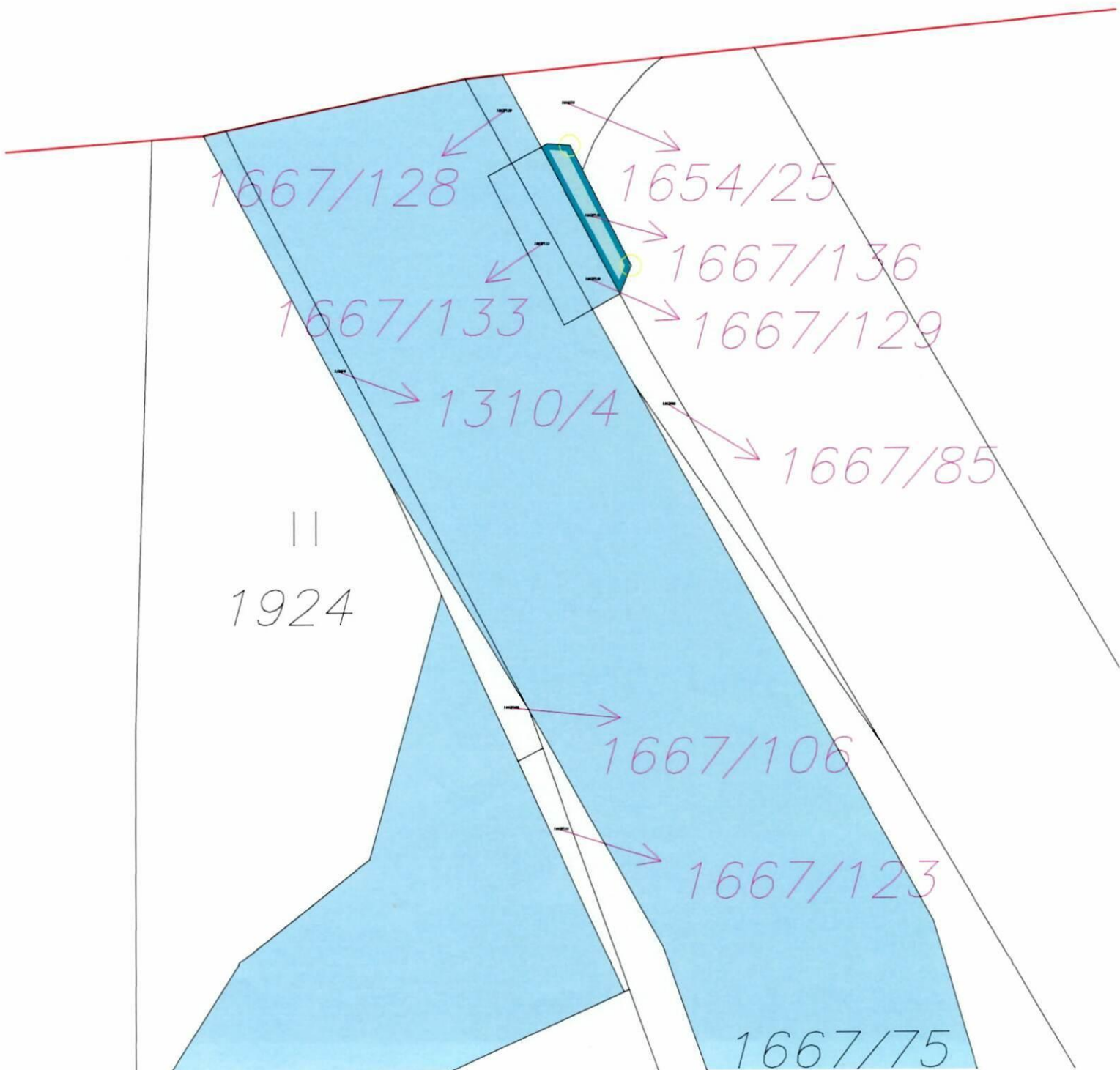



1667/128
1654/25
1667/136
1667/129
1667/133
1310/4
1667/85

II
1924

1654/6

1654

1922

1923

1667/106

1667/123

1667/75

1667/1

1654/17

1956

1667/78

1667/84

1654/32

1667/79

2291

1667/60

1667/121

1667/2

1667/122

1667/61

2186

7105